



D8 REDPOINT



Note: the lens of the Redpoint is clear, the red light is emitted from LEDs





TECHNICAL DATA

Housing Material:	Cast Aluminium
Mounting Options:	Hanging Standing
Lens Material:	Polycarbonate
Temperature range:	-40 to +85 °C
Connector:	Deutsch (DT04-2P) built in. Mating part: DT06-2S
Weight:	525 g / 1,16 lb
Light Patterns:	Spot

FEATURES

-  Overheating Protection
-  Over-voltage Protection
-  Polarity Protection
-  CE - marked

TEST STANDARDS

-  Salt Spray ASTM B117 48 h
-  Vibration 12-200 Hz 3 Axis, 8 grms
-  Shock Tested 50 G 10 ms
-  IP69K
-  EN55025 / CISPR 25 Class 3,
ISO 7637-2, ISO 16750-2, ISO 10605,
EN610000-4-2, EN610000-4-3,
EN610000-4-4, EN610000-6-3

For further information visit www.tyrilights.com or contact your local sales team.

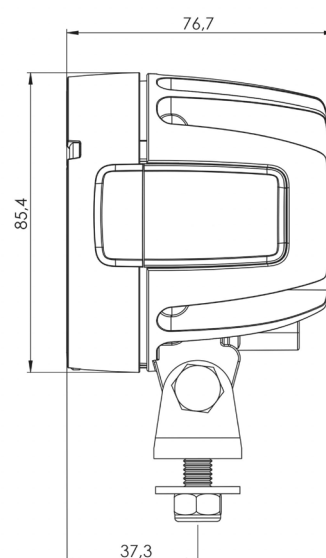
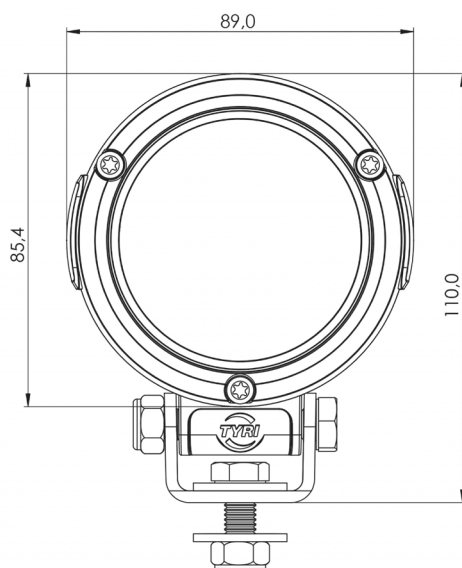



D8
REDPOINT

LIGHT OUTPUT		VOLTAGE		AMP DRAW		POWER	DOMINANT WAVELENGTH	EMC	ECE
Candela		Machine	Operating	12 V	24 V	Watts	nm	EN55025 / CISPR25	ECE Rating
25,000 cd		12-48 V	9-60 V	0,9 A	0,5 A	15 W	630 nm	3	-

LED work lights are exposed to dirt, fertilizers, road salt, acids and more. For best performance and long lifetime, the lens and the cooling fins must be cleaned on a regular basis.