



1010 FLUSH

The 1010 Flush has no cooling flanges and must be directly mounted on the surface of the vehicle where the metal of the machine is used to create a cooling effect for the light emitting diodes. Thanks to the flush design it is a perfect choice for confined spaces.



TECHNICAL DATA

Housing Material:	Cast Aluminium
Mounting Options:	Flush
Lens Material:	Polycarbonate & Grillamid
Temperature range:	-
Connector:	Deutsch (DT04-2P) built in Mating part: DT06-2S
Weight:	413 g / 0,91 lb
Light Patterns:	Narrow Symmetric Medium Symmetric Wide Symmetric Medium Asymmetric Wide Asymmetric Spot

FEATURES

- Overheating Protection
- Over-voltage Protection
- Polarity Protection
- CE - marked

TEST STANDARDS

-
- Vibration 5-2000 Hz 3 Axis, 8 Grms
- Shock Tested 50 G 10 ms
- IP69K
- EMC EN55025 / CISPR 25 Class 5
ISO7637-2, ISO16750-2,
ISO10605, ISO11452-2,
ISO10452-4, EN61000-4-2,
EN61000-4-3
- ECE R10

For further information visit www.tyriLights.com or contact your local sales team.

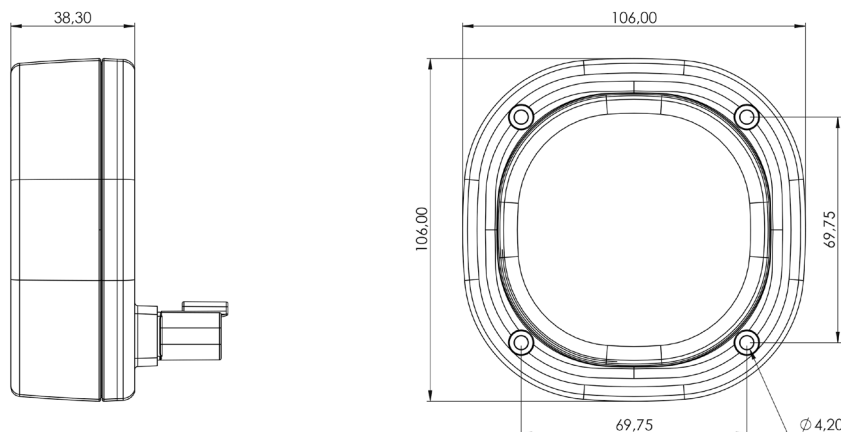



1010 FLUSH

LIGHT OUTPUT	VOLTAGE		AMP DRAW		POWER	COLOUR TEMPERATURE	EMC	ECE
	Machine	Operating	12 V	24 V			Watts	K
700 eLm	12-48 V	9-60 V	1,3 A	0,6 A	15 W	5,700 K	5	R10
1,800 eLm	12-48 V	9-60 V	2,4 A	1,2 A	29 W	5,700 K	5	R10

LED work lights are exposed to dirt, fertilizers, road salt, acids and more. For best performance and long lifetime, the lens and the cooling fins must be cleaned on a regular basis.