



BASEline™ S2

The BASEline range is a new cost-effective professional lighting solution from TYRI.

The combination of TYRI's advanced production methods and cutting-edge design ensures exceptional light quality at a highly competitive price. Tested to TYRI's high standards and produced in Sweden, UK and USA.



Available with up to 2,500 effective lumen output and tested to TYRI's high standards.



TECHNICAL DATA

Housing Material:	Plastic
Mounting Options:	Hanging Standing
Lens Material:	Polycarbonate
Temperature range:	-40 to +85 °C
Connector:	Deutsch (DT04-2P) built in. Mating part: DT06-2S
Weight:	460 g / 1,01 lb
Light Patterns:	Medium Symmetric

FEATURES

-  Overheating Protection
-  Over-voltage Protection
-  Polarity Protection
-  UL Optional

TEST STANDARDS

-  Salt Spray ASTM B117 500 h
-  Vibration 5-2000 Hz 3 Axis, 10 Grms
-  Shock Tested 50 G 11 ms
-  IP69K
-  EN55025 / CISPR 25 Class 5, ISO7637-2, ISO16750-2, ISO10605, ISO11452-2, ISO11452-4, EN61000-4-2, EN61000-4-3, EN61000-4-4, EN61000-6-2, EN61000-6-3
-  R10 & R148, see below

For further information visit www.tyrilights.com or contact your local sales team.

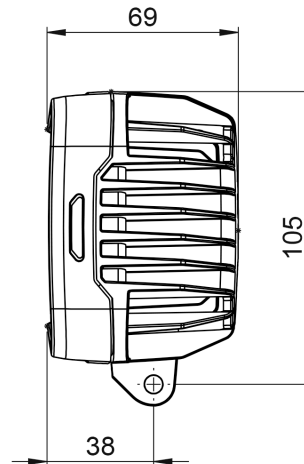
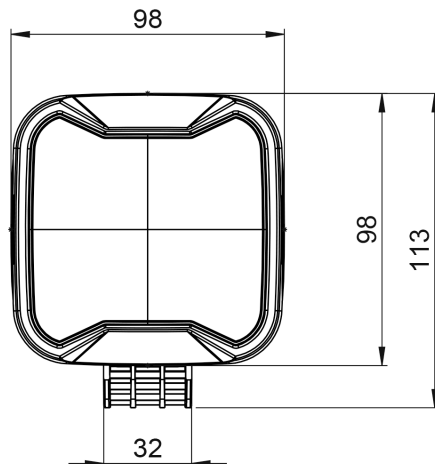



BASEline™ S2

LIGHT OUTPUT	VOLTAGE		AMP DRAW		POWER	COLOR TEMP	LENS PATTERN	PART NO.	EMC	ECE
	Machine	Operating	12 V	24 V					Watts	K
2,000 eLm	12 V	9-16 V	1,9 A	-	26 W	5,700 K	Medium Symmetric		5	R10 + R148
2,000 eLm	24 V	18-32 V	-	1,2	26 W	5,700 K	Medium Symmetric		5	R10 + R148
2,000 eLm	12-24 V	9-32 V	1,9 A	1,2	26 W	5,700 K	Medium Symmetric		5	R10 + R148
2,500 eLm	12 V	9-16 V	2,2 A	-	31 W	5,700 K	Medium Symmetric		5	R10
2,500 eLm	24 V	18-32 V	-	1,1 A	31 W	5,700 K	Medium Symmetric		5	R10

* Measurements made at charging voltage 14 V for 12 V systems and 28 V for 24 V systems.

TYPICAL LIGHT PATTERNS

Example for BASEline S2 / 2,500 effective lumen.

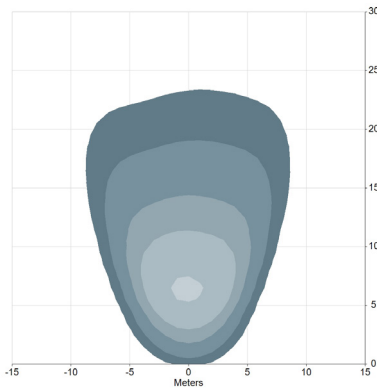

BASEline S2 / 2,500 eLm

Medium, 31 - 45°
3.0 m / -15°
Symmetric

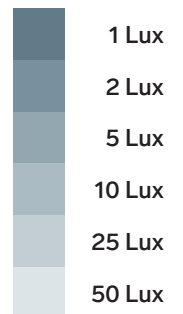

LED work lights are exposed to dirt, fertilizers, road salt, acids and more. For best performance and long lifetime, the lens and the cooling fins must be cleaned on a regular basis.