

Manual for Quick Controller by TYRI

Installation:

The controller is automatically visible when searching for devices in the app. Once the controller is paired with a network, it is no longer visible to other networks.

If you want to know the controller name, you can find it under  About on the device and then "Version".

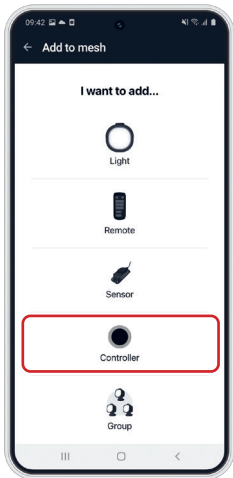

Basic function

Button press:



Short press, on M5 area or the whole wheel, to exit a menu.



Press and hold down the wheel, and turn simultaneously for quick access to operational menus (Color/Bright/Group)

Touchscreen:

Touch and hold to select or activate a function.



Use one finger to turn the lights on and two fingers to turn the lights off.

Follow the instructions shown on the screen regarding touch functions.

Operational menu



Color

Adjust the color temperature of the lights by turning the grey wheel.



Brightness

Adjust the brightness of the lights by turning the grey wheel.



Group

Scroll between lamp groups using the grey wheel and select group via touchscreen.

Manual for Quick Controller by TYRI

Update:

Follow the instructions in the app under firmware update.

01.

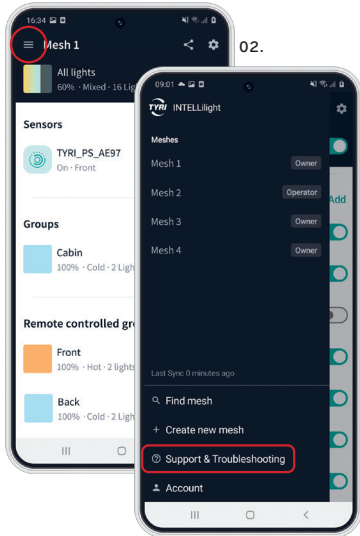

02.

03.

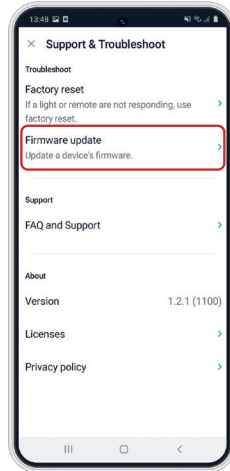

04.

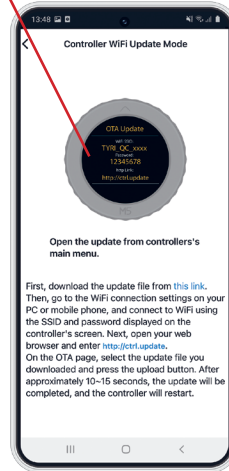

Update

WIFI SSID / Password / http Link



Utility

Restart: Restarts without disconnecting power.

Settings: Reset, Only affects settings on the controller, Beep on/off, Black and white screen on/off, Default Group, Stepsize, Backlight.

Factory: Reset, deletes connection to network and all settings

Beep on/off: Mutes the sound in the controller.

B/W: Black and white screen ON/OFF, Changes the screen background in the menus- Color/Bright/Group.



Backlight

Change the screen backlight.



About

Version: Current firmware and unique name of the controller.

Hardware

Flash: Memory counter.



LCD

Screen function test tool



Def, Group

Choose a group as default at startup



StepSize

Change dim step 5-20 per rotary click.

